

GMTA Region Auditions Checklist

Instructions for Mac/OS

(Follow Directions included in the GMTA Video Auditions Packet)

Student Region Auditions Checklist

It is very important to set up the accounts and save your recordings as noted in the attached directions. Please carefully read and follow attached directions.

_____1. Record one video of your two Audition pieces. Video may be paused between selections. Pieces may be recorded separately but must be combined into a single video submission.

_____2. Create a new account on YouTube for GMTA Auditions. (You do not need to create a new YouTube account if you already created one for GMTA Auditions)

_____3. Create a GMTA Audition Channel on YouTube

_____4. Upload your video recording to YouTube

_____5. Send YouTube link to your teacher as soon as you have the YouTube video created. Your teacher should receive your link no later than **March 8th** for ample time to load your link of the GMTA registration form.

_____6. **New for 2023** – Each student registered for GMTA Regional Auditions will upload PDF scores of the music selections performed in video recording.

These files will be uploaded by completing this form:

<https://forms.gle/FXnPbo8h4B3Tuiw28>

How do I scan my music? <https://www.wikihow.com/Scan-Documents-Into-PDF>

Please follow all instructions below in the
GMTA Video Region Auditions Packet

GMTA Video Region Auditions Instructions Packet

Instructions for Video Recording

Recording Location

You should record your video in the spirit of a live audition or recital performance. You may record in a home, school, church, synagogue, recital hall, rehearsal room, or studio with good natural acoustics with or without an audience. You should dress professionally, as you would for a recital or live audition.

Recording

- A tablet or smartphone is all you need.
- Find a quiet place.
- Your camera should record from a fixed position. Set up device to capture the student, their hands and the instrument. Treat the camera as if it were the judge.
- Videos must contain all repertoire listed on the original application. Entrants should NOT introduce themselves or announce the piece being recorded.
- Baroque/Classical piece should be performed first, followed by Romantic/Contemporary piece.

Execution

- Run a technical dress rehearsal with everything in place.
- Test the sound. Move recording device, if needed.

Recording Guidelines

- Record one video for all of your pieces. Video may be paused between repertoire selections. Following the guidelines of MTNA, two separate recordings may be used but must be combined into one video. GMTA will only be able to accept one video link.

Treat this as a live audition

- Dress appropriately
- Keep playing from start to finish! The performance quality may diminish after 3-5 takes and it is better to have one complete recording than none.

Transfer File

- Upload your recording to YouTube. Follow directions outlined below by GMTA to upload your recording on YouTube
- You will send YouTube link to your teacher for submission to GMTA Region Auditions
- DO NOT WAIT UNTIL THE LAST DAY TO SUBMIT VIDEOS.

YouTube Account

To ensure that identifying info is not included on your video, please create a new account following the instructions below. If you already have a YouTube account, you will need to use a different email address to create a YouTube account to be used for GMTA Auditions. You can set up a new Gmail account by clicking - [How to Create a Gmail Email Address](#)

Creating a new account on You Tube for GMTA Auditions

1. [Click Here](#) to go to [YouTube](#).
2. In the top right, click **Sign in**.



3. Click **Create Account**.

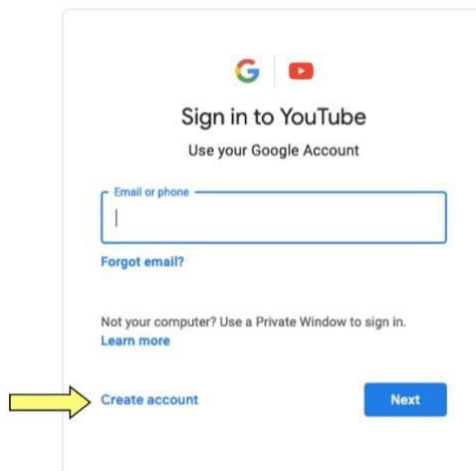

4. Choose **For myself**
5. Complete form to create account. When complete, click "Next" and "Save."

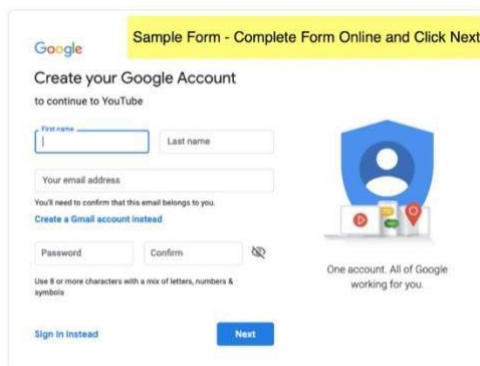
A screenshot of the Google account creation form. The page has a white background with the Google logo at the top left. The title is 'Sample Form - Complete Form Online and Click Next'. Below the title, it says 'Create your Google Account to continue to YouTube'. There are several input fields: 'First name', 'Last name', 'Your email address', 'Password', and 'Confirm'. There is also a link for 'Create a Gmail account instead'. At the bottom, there are two buttons: 'Sign in instead' and 'Next'. A yellow highlight is present at the top of the page.

Updated Instructions for GMTA Region Auditions

Creating a “GMTA Audition” Channel on You Tube

After creating a YouTube account for GMTA Auditions, please create a channel following the instructions below:

1. Click the video () icon on the top right corner. Choose “upload a video.”



2. Click “Select” to Use a custom name

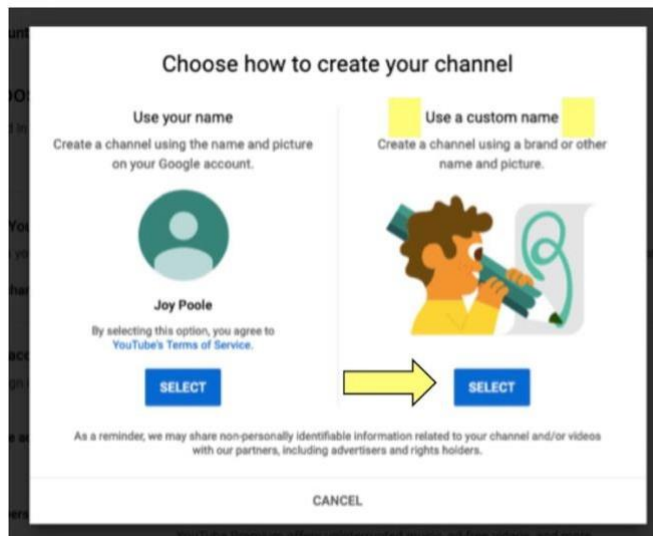

3. **Very Important! Name your channel:** Add “GRADE__REGISTRATION#_ REGION” using the info provided to you by email.

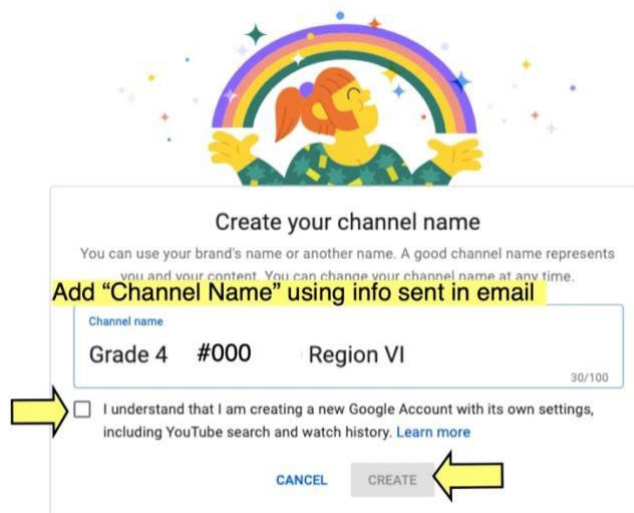

4. Click “box” next to “I understand that I am creating.... “

5. Click "Create"
6. On next screen, add phone number to receive verification code

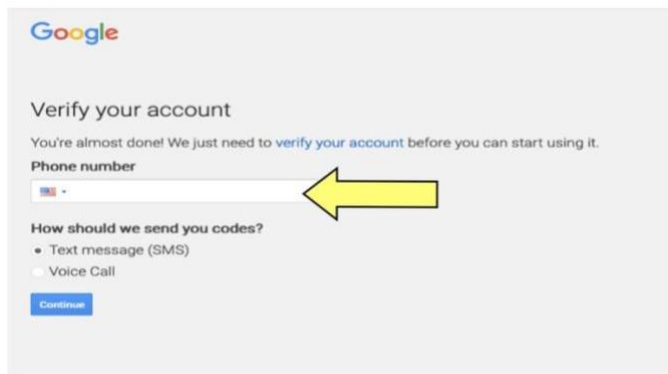

7. When received, add verification code

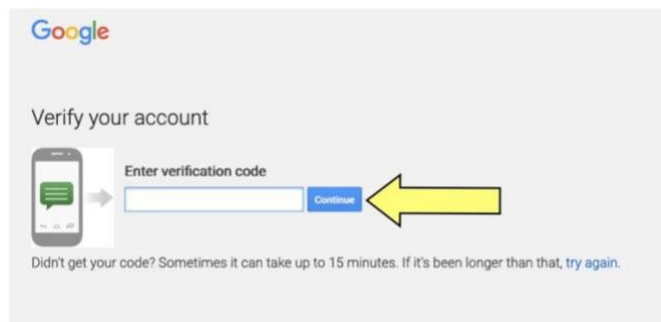

8. Click to continue
9. On next screen, **do not** add picture or any other personal info

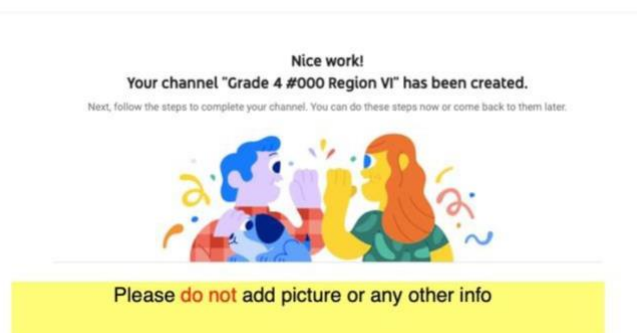

10. Scroll to bottom of this page (do not add any info) and click "Set Up Later"



11. You are now ready to upload your video

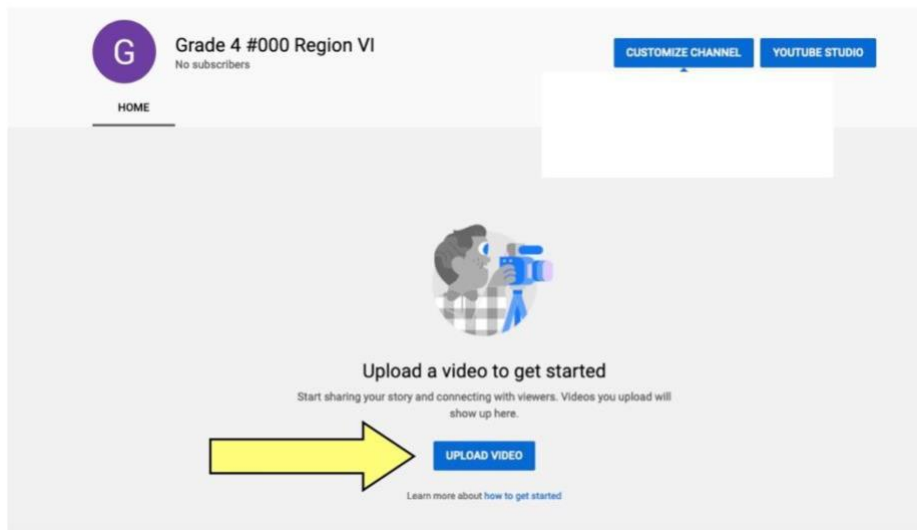

12. On the next screen, Click Next

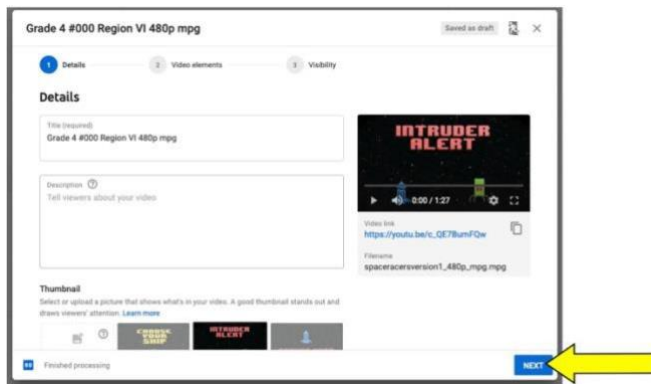

13. Choose "Unlisted" and the "Save"

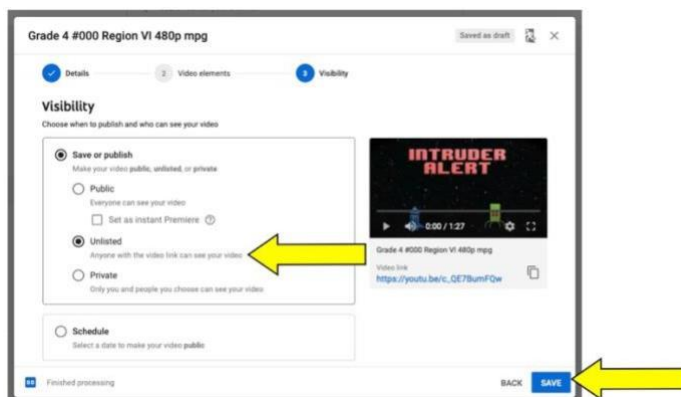

14. Video is published

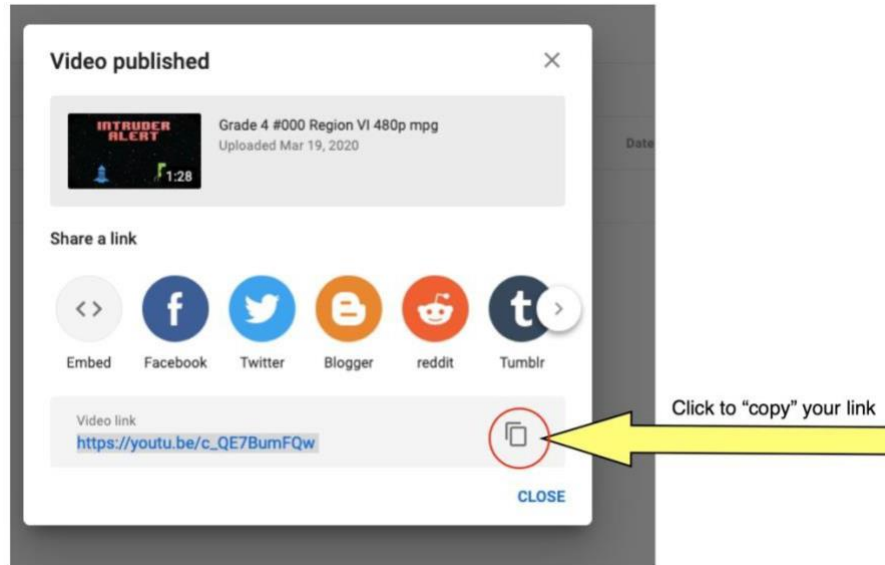

15. Email your teacher.

Please double check the link to make sure it works before submitting link to your teacher.

In your email include:

- a. Student Name
- b. Paste the link (Right-Click, Choose "Paste") that you copied from YouTube saved as "Grade ___ Registration # ___ Region ___".

Invalid Videos

The following video problems would make them invalid.

- Videos revealing the teacher's identity, the city of the performer or name. Please follow instructions for creating a new YouTube Account and Channel
- Videos with "private" sharing options (see above).
- Videos that pan and zoom during performances.
- Videos that are digitally altered

Additional Resources:

- [How to Create a Gmail Email Address](#)
- [How to Create a YouTube Account and You Tube Channel](#)